



Portofino I

Job 2616-ST

71 Silverstone Drive, Stony Plain

1,522 Sq.Ft

9'-1" Main Floor Ceiling Height

Luxury Vinyl Plank throughout Main Floor

Side Entrance

Electric Fireplace in Great Room

Appliance Allowance

Quartz Countertops in Kitchen & Bathrooms

Tile in all Second Floor Bathrooms

Stand-up Shower in Ensuite

High Efficiency Furnace

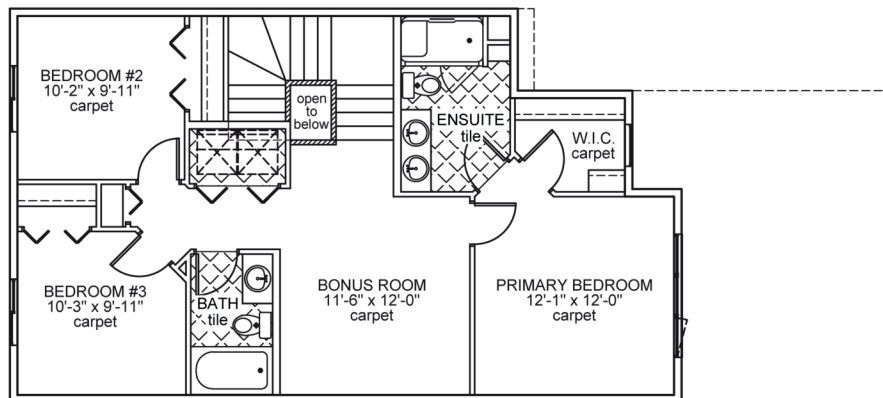

Upper Floor Area: 844 sqft

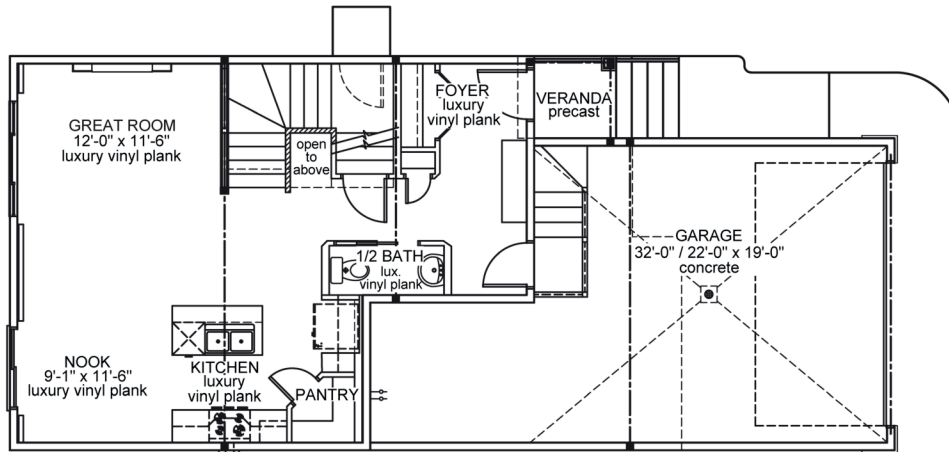

Main Floor Area: 678 sqft

JOB 2616-ST - www.montorio.ca