



Portofino I

Job 2526-ST

74 Silverstone Drive, Stony Plain

1,522 Sq.Ft
9'-1" Main Floor Ceiling Height
Vinyl Plank throughout Main Floor
Side Entrance
Appliance Allowance
Quartz Countertops in Kitchen & Bathrooms
Electric Fireplace in Great Room
Tile in all Second Floor Bathrooms
Stand-up Shower in Ensuite
Triple Pane Windows
High Efficiency Furnace

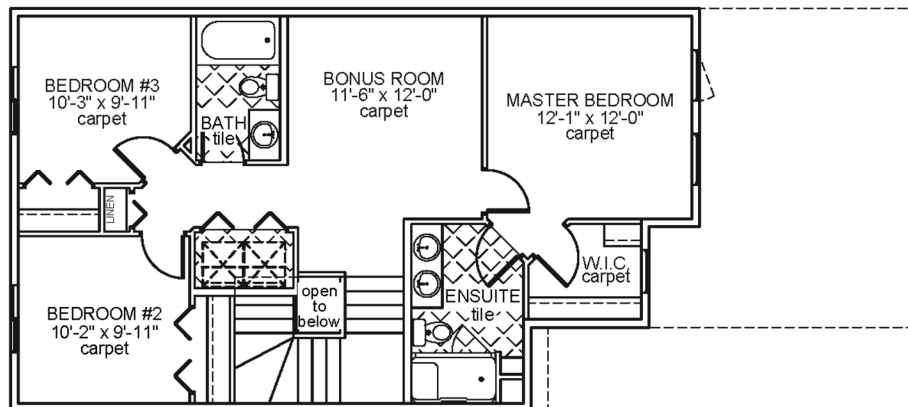

Upper Floor Area: 844 sqft

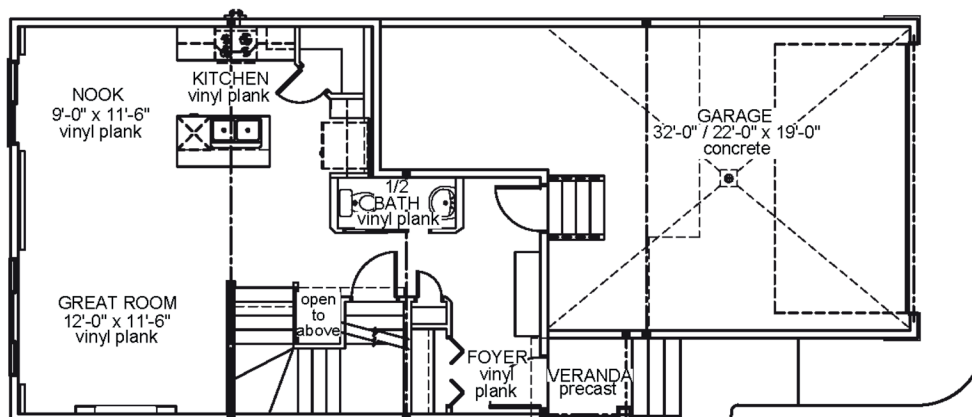

Main Floor Area: 678 sqft

JOB 2526-ST - www.montorio.ca