



# Portofino I

**Job 2526-ST**

**74 Silverstone Drive, Stony Plain**

- 1,522 Sq.Ft
- 9'-1" Main Floor Ceiling Height
- Vinyl Plank throughout Main Floor
- Side Entrance
- Appliance Allowance
- Quartz Countertops in Kitchen & Bathrooms
- Electric Fireplace in Great Room
- Tile in all Second Floor Bathrooms
- Stand-up Shower in Ensuite
- High Efficiency Furnace

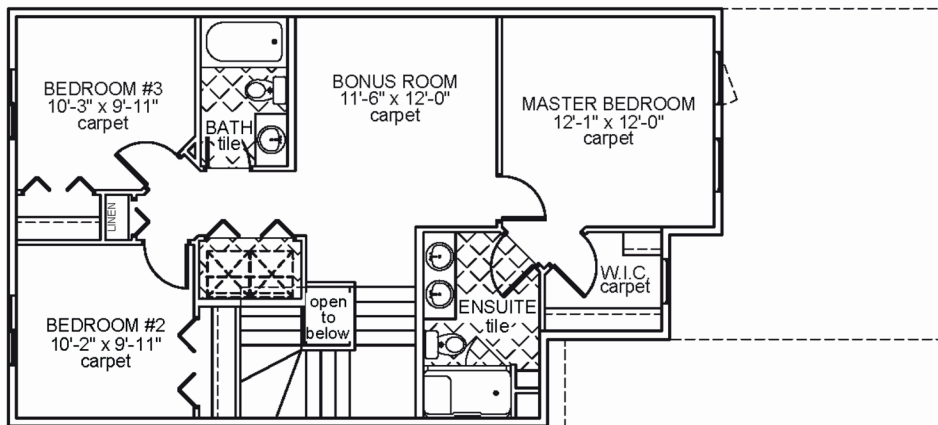

Upper Floor Area: 844 sqft

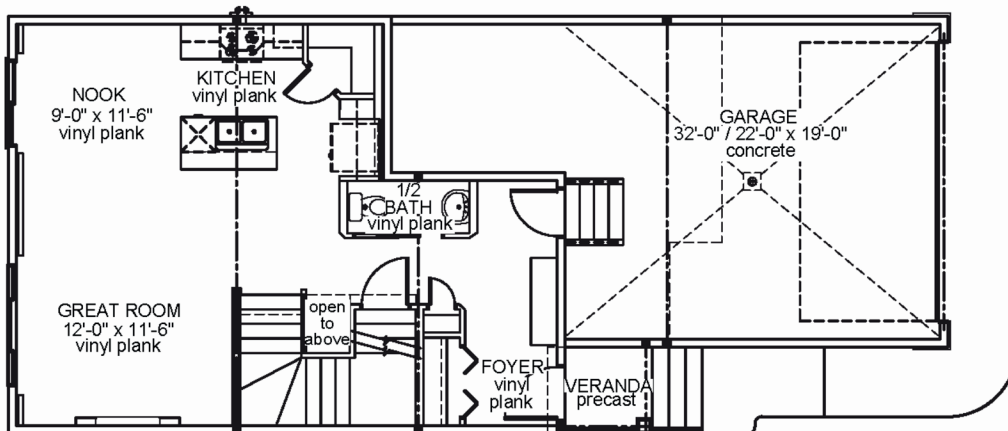

Main Floor Area: 678 sqft

JOB 2526-ST - [www.montorio.ca](http://www.montorio.ca)