



Portofino I

Job 2592-ST

87 Silverstone Drive, Stony Plain

- 1,522 Sq.Ft
- 9'-1" Main Floor Ceiling Height
- Luxury Vinyl Plank throughout Main Floor
- Side Entrance
- Appliance Allowance
- Quartz Countertops in Kitchen & Bathrooms
- Tile in all Second Floor Bathrooms
- Stand-up Shower in Ensuite
- High Efficiency Furnace

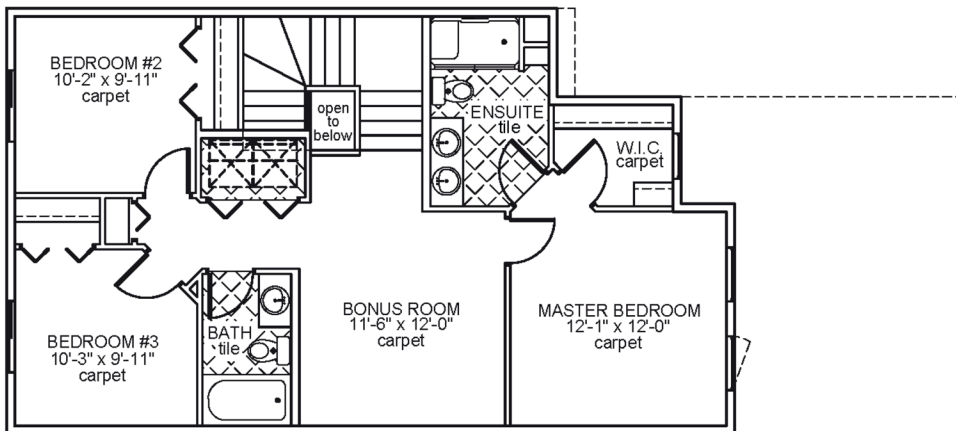

Upper Floor Area: 844 sqft

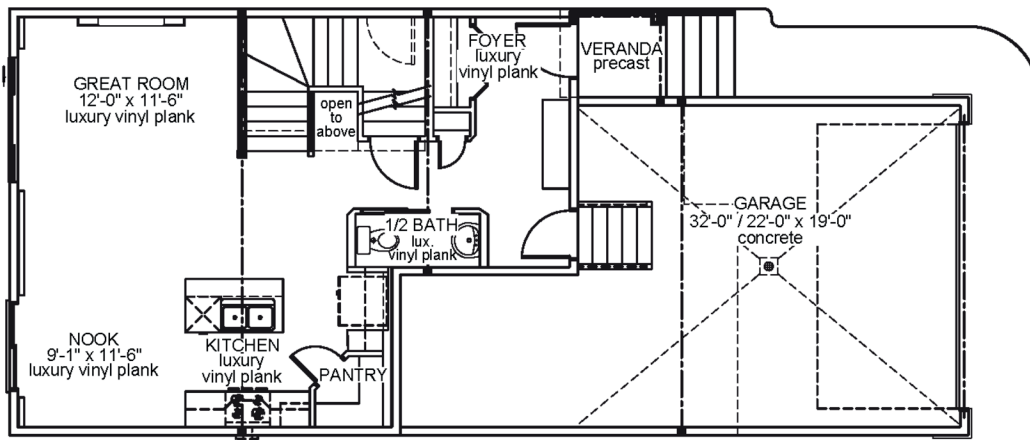

Main Floor Area: 678 sqft

JOB 2592-ST - www.montorio.ca

