

# Salerno I

**Job 2531-GR**

**15851 - 29 Avenue SW**



- 2,131 sqft
- 9'-1" Main Floor Ceiling Height
- Vinyl Plank throughout Main Floor
- Appliance Allowance
- Smart Home Security System
- Electric Fireplace in Great Room
- Railing Throughout
- Bedroom & Full Bath on Main Floor
- Quartz Countertops in Kitchen & Bathrooms
- Tile in all Second Floor Bathrooms
- Stand-up Shower in Ensuite
- Drop-in Tub in Ensuite
- Triple Pane Windows
- High Efficiency Furnace

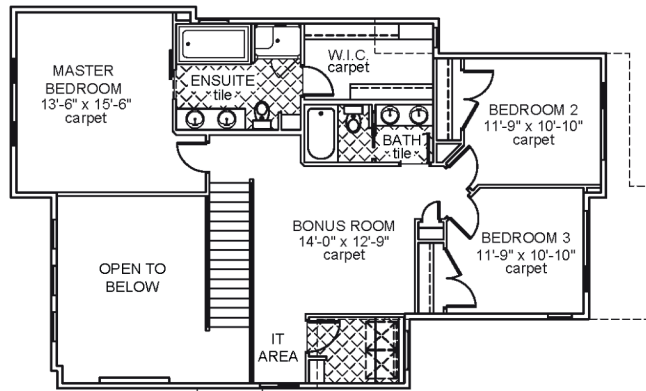

Upper Floor Area: 1170 sqft

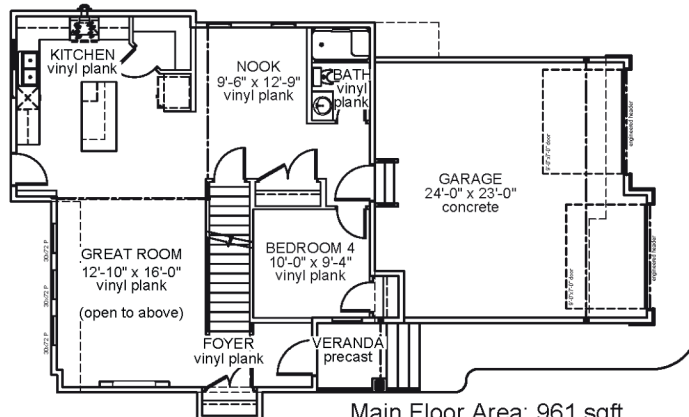

Main Floor Area: 961 sqft

JOB 2531-GR - [www.montorio.ca](http://www.montorio.ca) - 587-521-8588