

Florence II

Job 2614-TP

13113 - 212A Street NW



2,354 Sq.Ft.

9'-1" Main Floor Ceiling Height

Luxury Vinyl Plank throughout Main Floor

Side Entrance

Appliance Allowance

Quartz Countertops in Kitchen & Bathrooms

Smart Home Security System

Walk out Basement

2-Way Gas Fireplace in Great Room & Nook

Bedroom & Full Bath on Main Floor

Railing Throughout

Tile in all Second Floor Bathrooms

Stand-up Shower in Ensuite

Tiled Shower in Ensuite

Drop-in Tub in Ensuite

\$17,000 in Interior Design Upgrades

Triple Pane Windows

High Efficiency Furnace

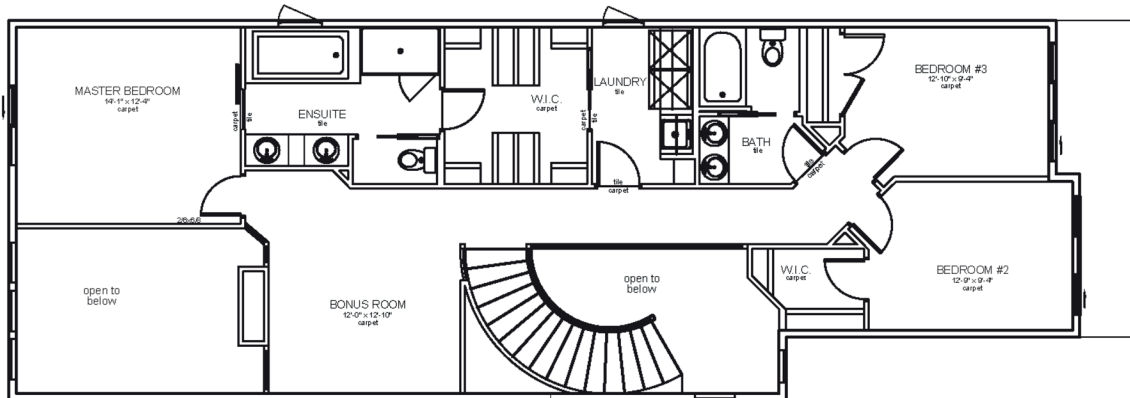

Upper Floor Area: 1212 sqft

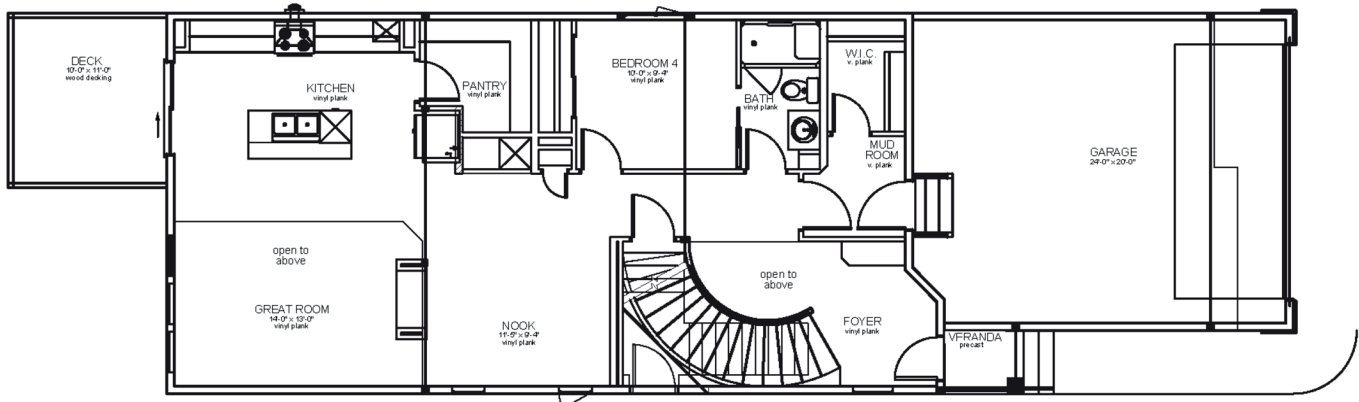

Main Floor Area: 1142 sqft

JOB 2614-TP - www.montorio.ca