

# Novara II

**Job 2576-DM**

**90 Dansereau Way, Beaumont**



- 1,058 sqft
- 9'-1" Main Floor Ceiling Height
- Luxury Vinyl Plank throughout Main Floor
- Quartz Countertops in Kitchen & Bathrooms
- Rough-In Smart Home Security System
- Tile in all Second Floor Bathrooms
- Appliance Allowance
- Dual Master Bedroom on Second Floor
- Stand-up Shower in Ensuite
- Double Detached Garage
- Rear Concrete Patio
- No Condo Fees
- Front & Rear Landscaping
- Super Common Wall System (Better Sound Barriers and Smell-Proof)
- High Efficiency Furnace

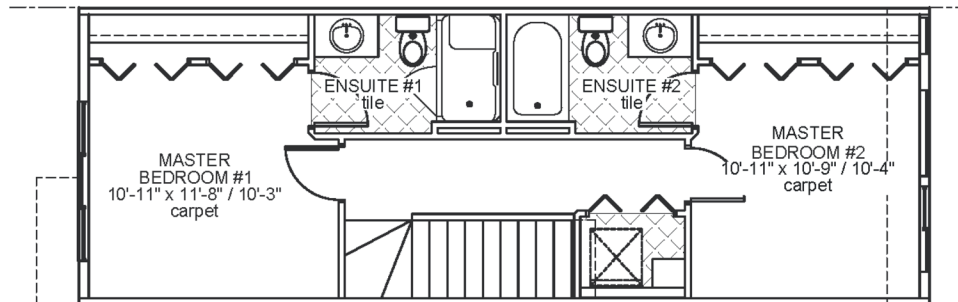

Upper Floor Area: 517 sqft

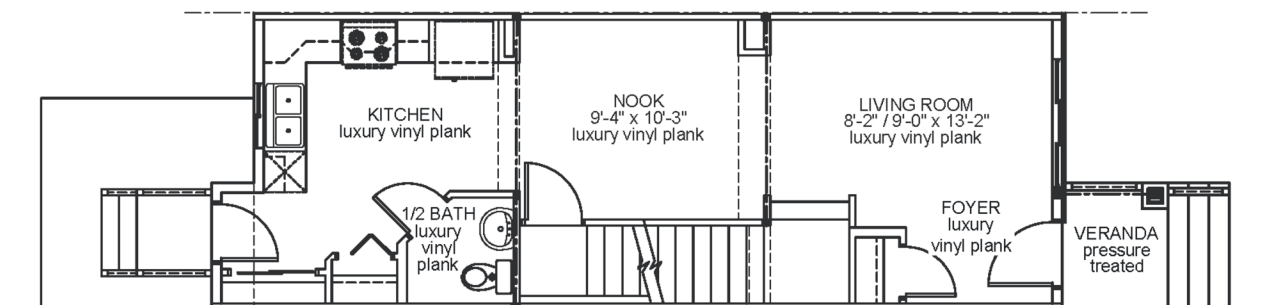

Main Floor Area: 541 sqft

JOB 2576-DM - [www.montorio.ca](http://www.montorio.ca) - 780-737-1549