

Salerno I

Job 2554-WB

106 Lilac Close, Leduc



2,355 Sq.Ft.

9'-1" Main Floor Ceiling Height

Luxury Vinyl Plank throughout Main Floor

Side Entrance

Appliance Allowance

Smart Home Security System

Quartz Countertops in Kitchen & Bathrooms

Electric Fireplace in Great Room

Bedroom & Full Bath on Main Floor

Railing Throughout

Tile in all Second Floor Bathrooms

Stand-up Shower & Drop-in Tub Ensuite

Tiled Shower in Ensuite

Rear Vinyl Deck with Aluminum Railing

Walkout Basement

\$17,000 in Interior Design Upgrades

Triple Pane Windows

High Efficiency Furnace

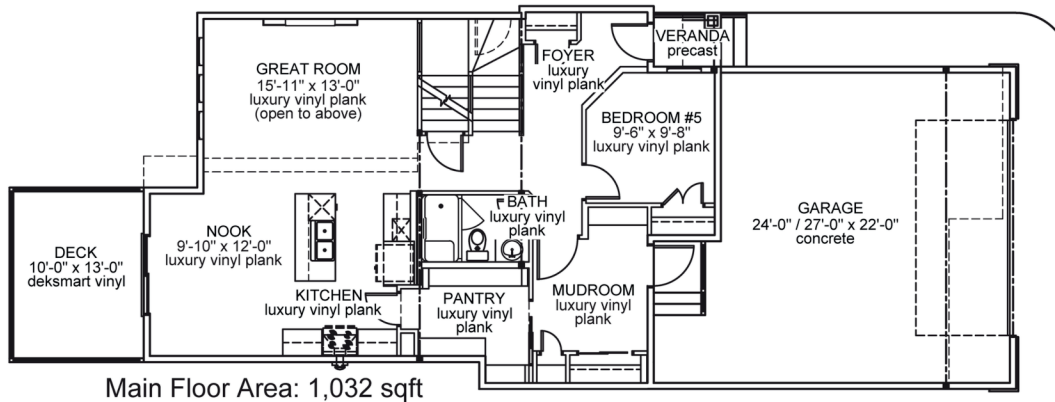
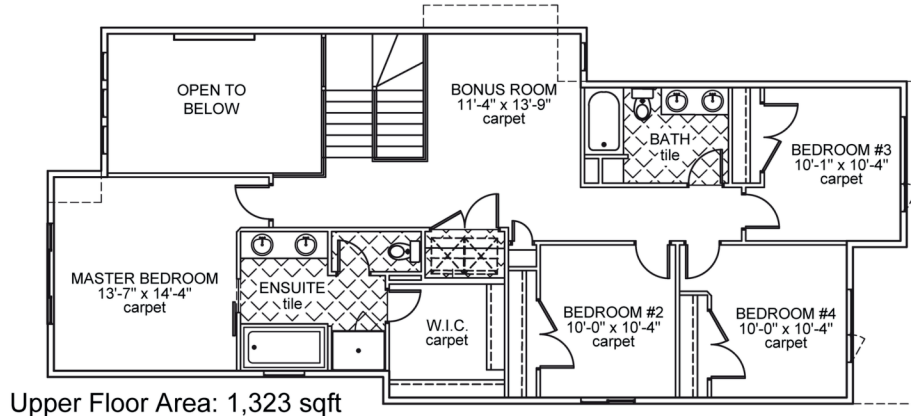

JOB 2554-WB - www.montorio.ca

