

# Venice I

## Job 2515-GR

### 15674 - 18 Avenue SW

- 2,362 Sq.Ft.
- 9'-1" Main Floor Ceiling Height
- Luxury Vinyl Plank throughout Main Floor
- Quartz Countertops in Kitchen & Bathrooms
- Smart Home Security System
- Appliance Allowance
- Electric Fireplace in Great Room
- Bedroom & Full Bath on Main Floor
- Side Entrance
- Railing Throughout
- Tile in all Second Floor Bathrooms
- Stand-up Shower in Ensuite
- Drop-in Tub in Ensuite
- Triple Pane Windows
- High Efficiency Furnace

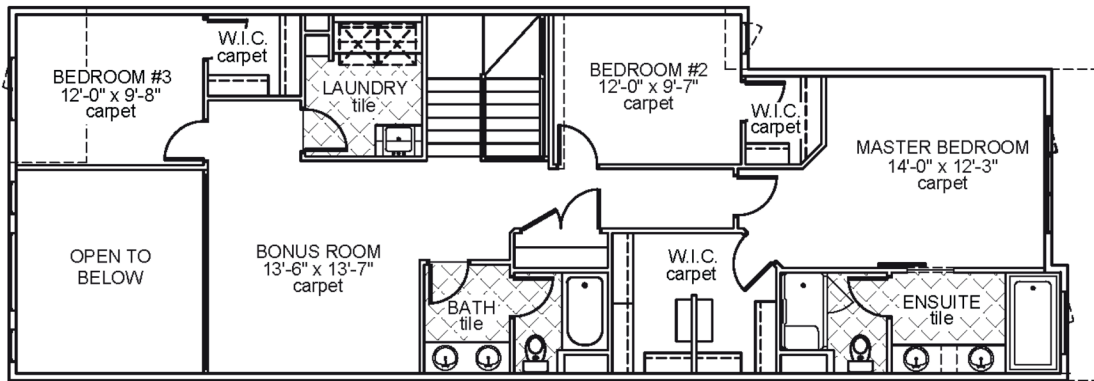

Upper Floor Area: 1308 sqft

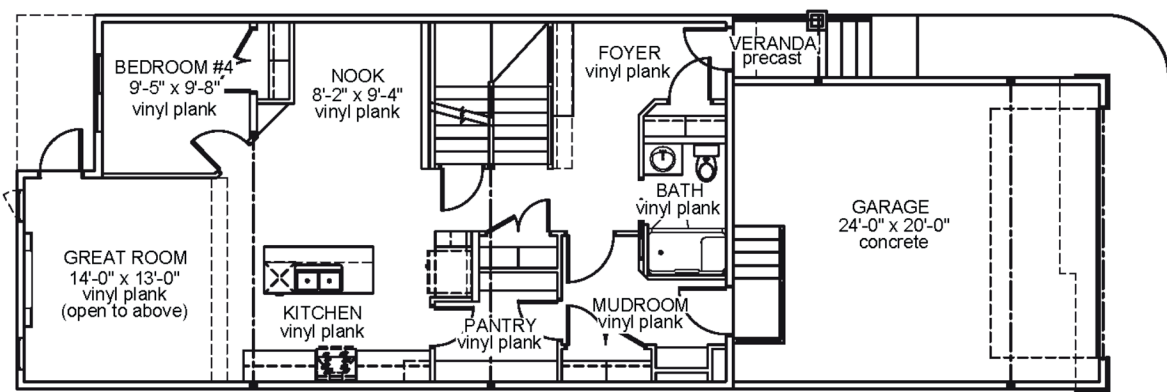

Main Floor Area: 1054 sqft

JOB 2515-GR - [www.montorio.ca](http://www.montorio.ca) - 587-521-8588