



# Salerno III

## Job 2473-FW

22 Kiwyck Link, Spruce Grove

2,001 Sq.Ft

9'-1" Main Floor Ceiling Height

Vinyl Plank throughout Main Floor

Appliance Allowance

Side Entrance

Electric Fireplace in Great Room

Bedroom & Full Bath on Main Floor

Quartz Countertops in Kitchen & Bathrooms

Tile in all Second Floor Bathrooms

Drop in Tub in Ensuite

Stand-Up Shower in Ensuite

High Efficiency Furnace

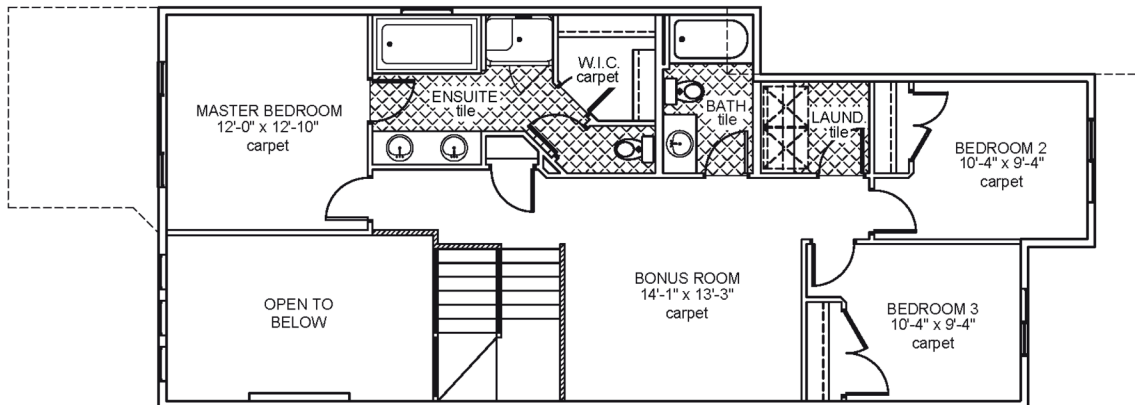

Upper Floor Area: 998 sqft

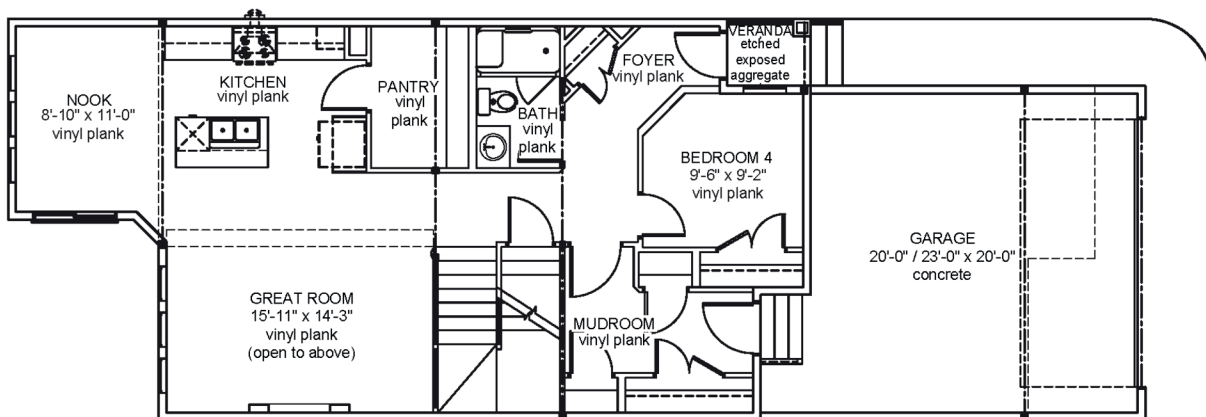

Main Floor Area: 1003 sqft

JOB 2473-FW - [www.montorio.ca](http://www.montorio.ca)