



Savona II

Job 2492-NWE

4637 - 114 Avenue, Edmonton

1,528 sqft

9'-1" Main Floor Ceiling Height

Vinyl Plank throughout Main Floor

Side Entrance

Appliance Allowance

Quartz Countertops in Kitchen & Bathrooms

Tile in all Second Floor Bathrooms

Stand-up Shower in Ensuite

Detached Garage

High Efficiency Furnace

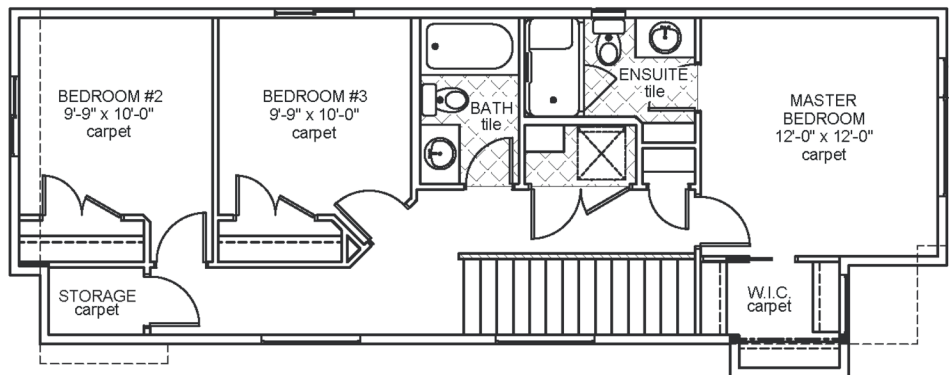

Upper Floor Area: 747 sqft

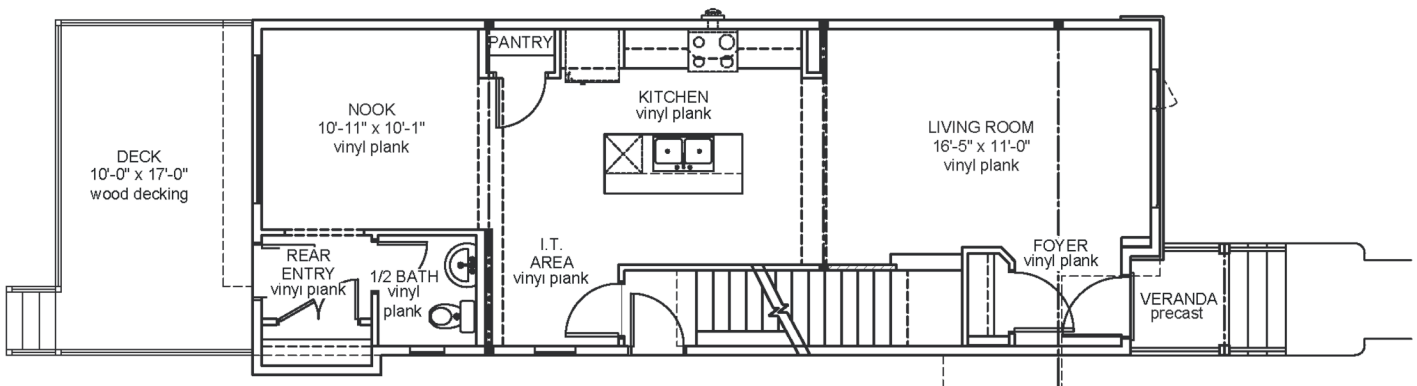

Main Floor Area: 781 sqft

JOB 2492-NWE - www.montorio.ca