



Camerano II

Job 2561-WB

223 Larch Crescent, Leduc

- 1,577 sqft
- 9'-1" Main Floor Ceiling Height
- Vinyl Plank throughout Main Floor
- Side Entrance
- Appliance Allowance
- Quartz Countertops in Kitchen & Bathrooms
- Tile in all Second Floor Bathrooms
- Stand-up Shower in Ensuite
- High Efficiency Furnace

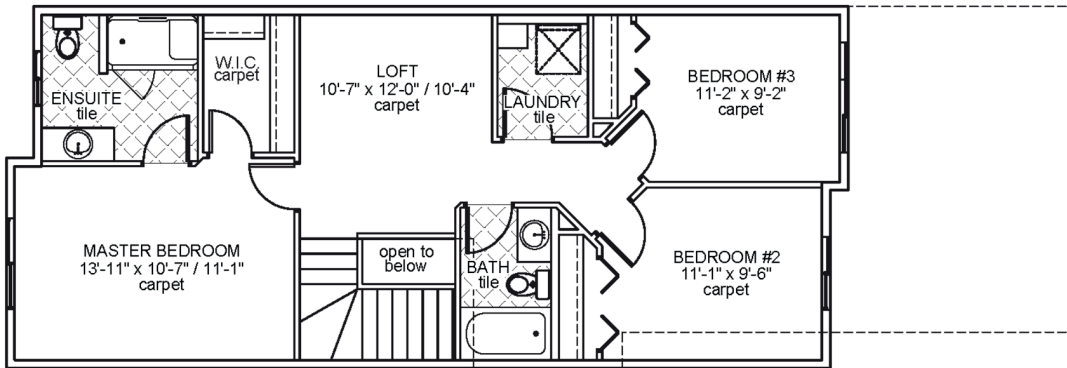

Upper Floor Area: 850 sqft

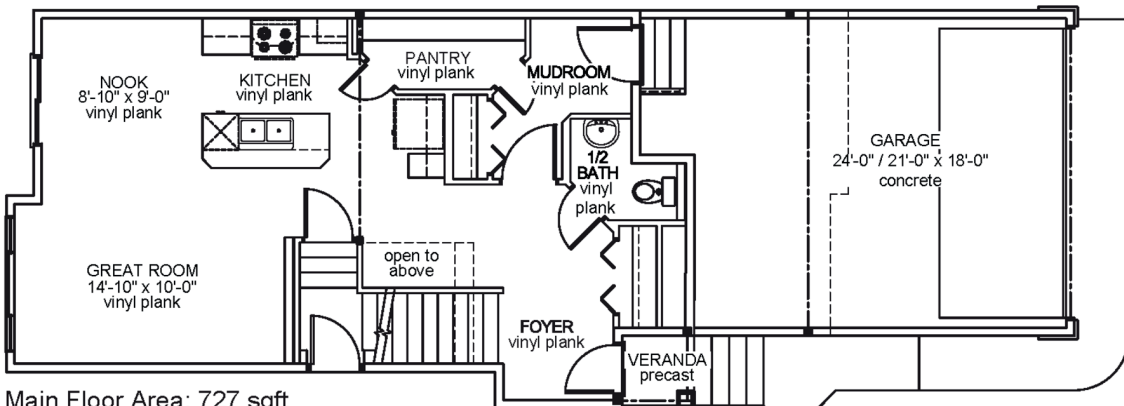

Main Floor Area: 727 sqft

JOB 2561-WB- www.montorio.ca