

# Novara II

**Job 2520-DM**

**84 Dansereau Way, Beaumont**



**1,272 sqft**

**9'-1" Main Floor Ceiling Height**

**Vinyl Plank throughout Main Floor**

**Quartz Countertops in Kitchen & Bathrooms**

**Tile in all Second Floor Bathrooms**

**Appliance Allowance**

**Stand-up Shower in Ensuite**

**Double Detached Garage**

**Rear Concrete Patio**

**No Condo Fees**

**Front & Rear Landscaping**

**Super Common Wall System (Better Sound Barriers and Smell-Proof)**

**High Efficiency Furnace**

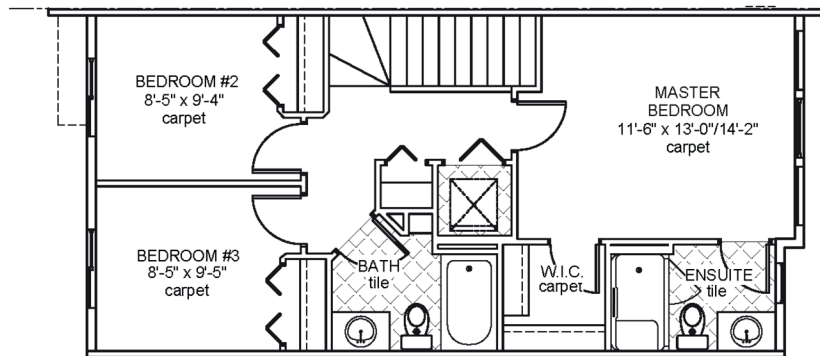

Upper Floor Area: 619 sqft

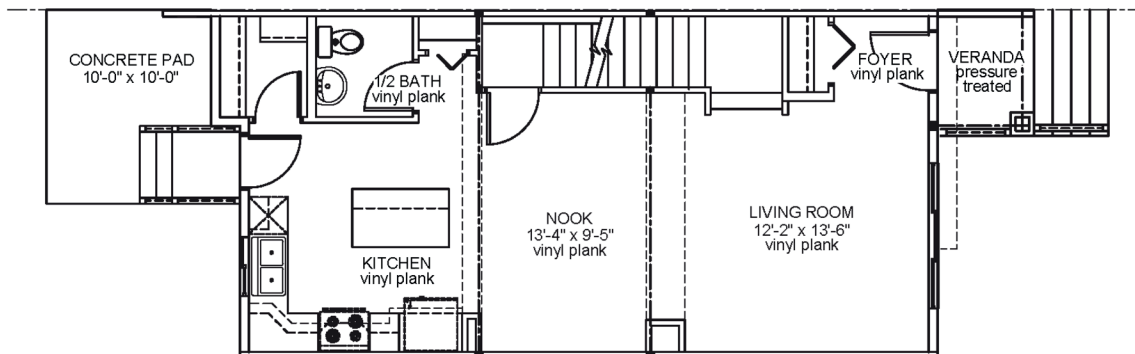

Main Floor Area: 654 sqft

JOB 2520-DM - [www.montorio.ca](http://www.montorio.ca) - 780-737-1549