



Salerno III

Job 2541-CO

87 Chambery Crescent, St. Albert

- 2,008 Sq.Ft
- 9'-1" Main Floor Ceiling Height
- Vinyl Plank throughout Main Floor
- Smart Home Security System
- Side Entrance
- Electric Fireplace in Great Room
- Railing Throughout
- Appliance Allowance
- Bedroom & Full Bath on Main Floor
- Quartz Countertops in Kitchen & Bathrooms
- Tile in all Second Floor Bathrooms
- Drop-In Tub in Ensuite
- Tiled Shower in Ensuite
- Triple Pane Windows
- High Efficiency Furnace

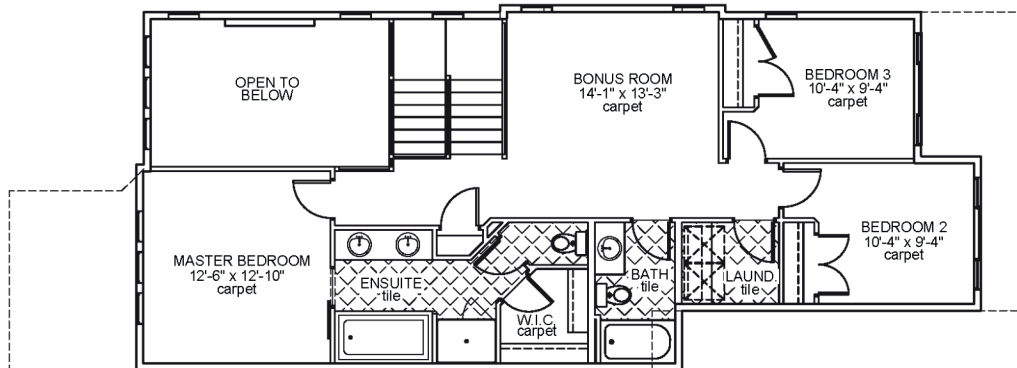

Upper Floor Area: 1005 sqft

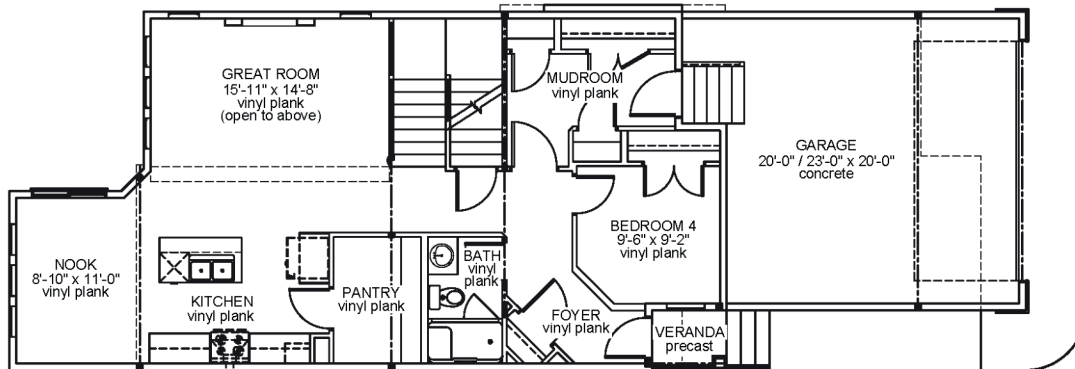

Main Floor Area: 1003 sqft

JOB 2541-CO - www.montorio.ca