



Dugenta VII

Job 2533-WB

229 Larch Crescent, Leduc

1,633 sqft

9'-1" Main Floor Ceiling Height

Vinyl Plank throughout Main Floor

Side Entrance

Appliance Allowance

Quartz Countertops in Kitchen & Bathrooms

Tile in all Second Floor Bathrooms

Stand-up Shower in Ensuite

High Efficiency Furnace

Includes Legal Fees (when using Montorio Homes' lawyer and approved lender)

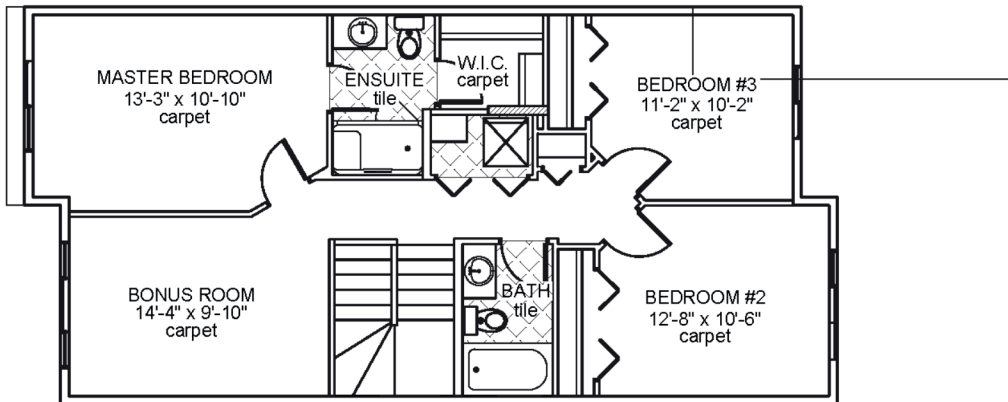

Upper Floor Area: 891 sqft

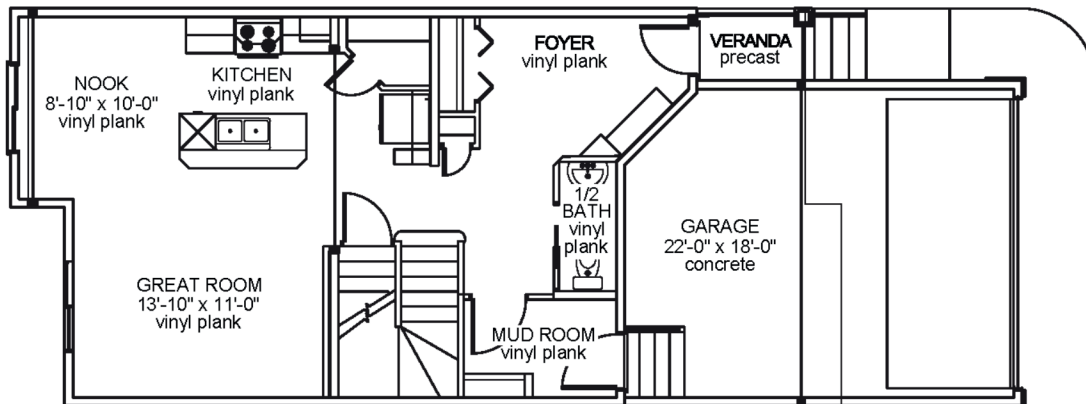

Main Floor Area: 742 sqft

JOB 2533-WB - www.montorio.ca