



# Dugenta VII

**Job 2533-WB**

**229 Larch Crescent, Leduc**

- 1,633 sqft
- 9'-1" Main Floor Ceiling Height
- Vinyl Plank throughout Main Floor
- Side Entrance
- Appliance Allowance
- Quartz Countertops in Kitchen & Bathrooms
- Tile in all Second Floor Bathrooms
- Stand-up Shower in Ensuite
- High Efficiency Furnace

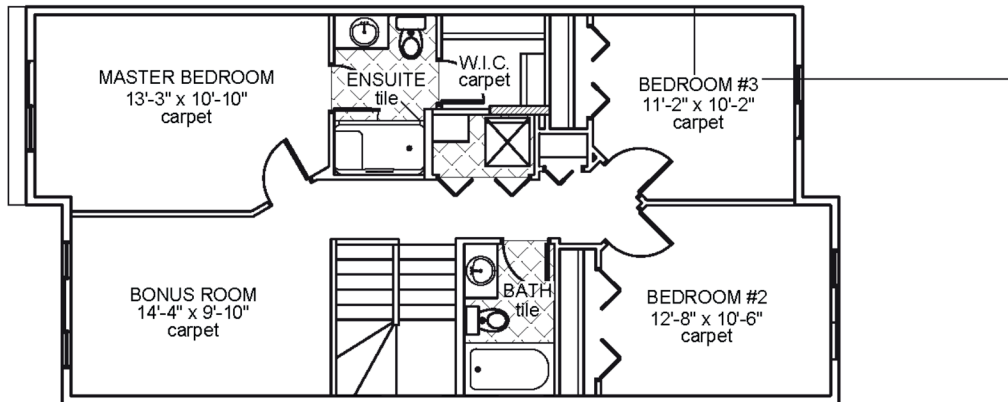

Upper Floor Area: 891 sqft

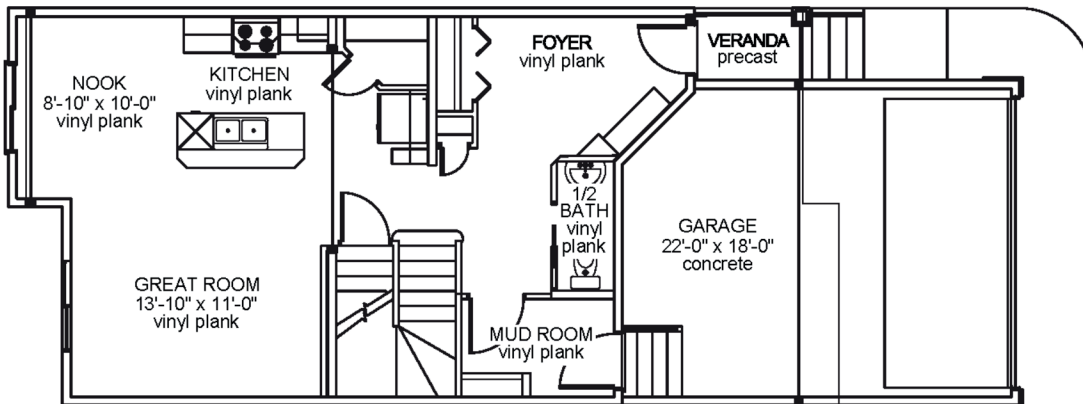

Main Floor Area: 742 sqft

JOB 2533-WB - [www.montorio.ca](http://www.montorio.ca)