

# Camerano II

**Job 2532-WB**

**231 Larch Crescent, Leduc**

1,545 sqft

9'-1" Main Floor Ceiling Height

Vinyl Plank throughout Main Floor

Side Entrance

Appliance Allowance

Quartz Countertops in Kitchen & Bathrooms

Tile in all Second Floor Bathrooms

Stand-up Shower in Ensuite

High Efficiency Furnace

Includes Legal Fees (when using Montorio Homes' lawyer and approved lender)

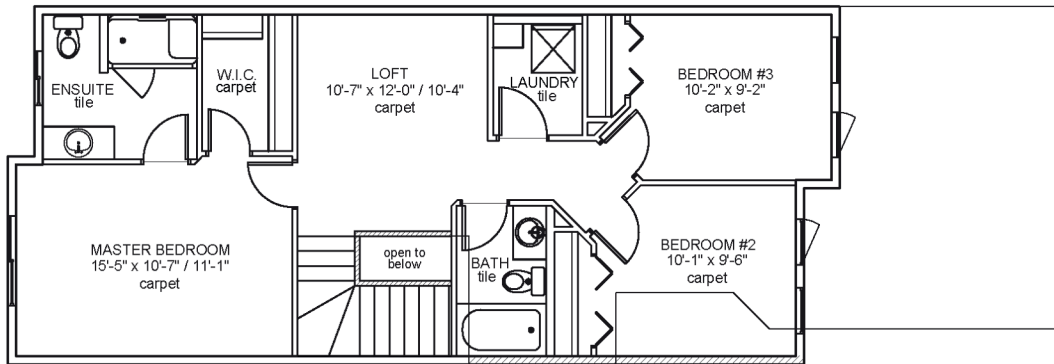

Upper Floor Area: 840 sqft

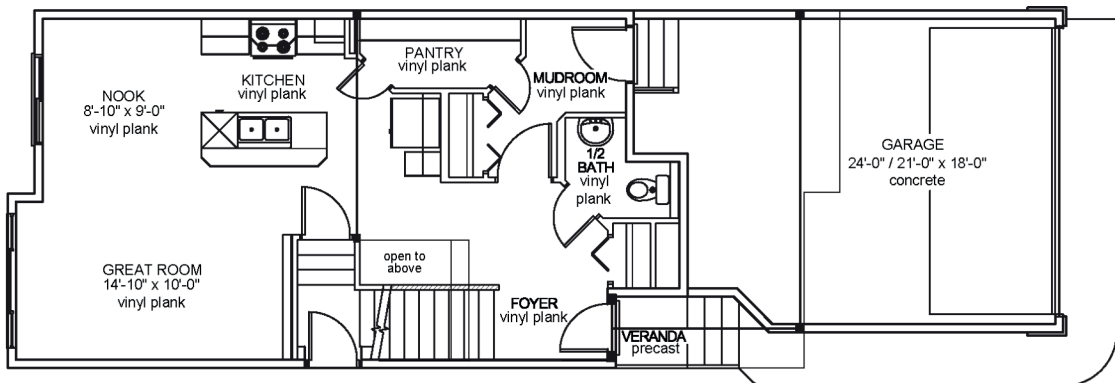

Main Floor Area: 705 sqft

JOB 2532-WB- [www.montorio.ca](http://www.montorio.ca)