

Ravello I

Job 2502-MC

6304 - 175 Avenue NW

1,747 sqft

9'-1" Main Floor Ceiling Height

Vinyl Plank throughout Main Floor

Side Entrance

Appliance Allowance

Bedroom & Full Bath on Main Floor

Electric Fireplace in Great Room

Quartz Countertops in Kitchen & Bathrooms

Tile in all Second Floor Bathrooms

Stand-up Shower in Ensuite

Triple Pane Windows

High Efficiency Furnace

Includes Legal Fees (when using Montorio Homes' lawyer and approved lender)

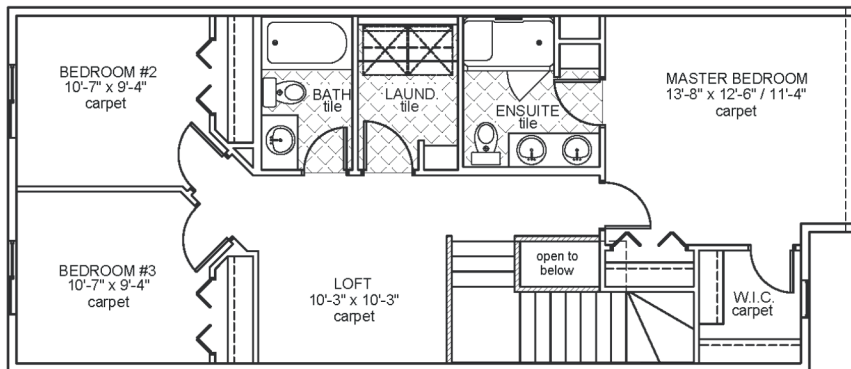

Upper Floor Area: 842 sqft

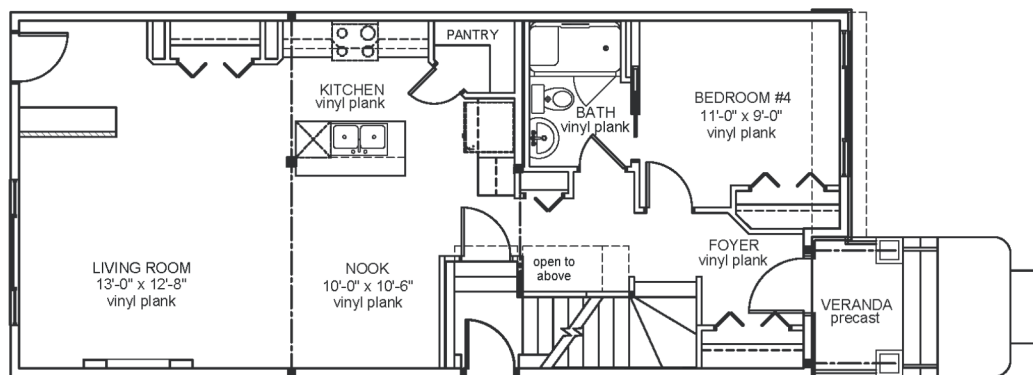

Main Floor Area: 905 sqft

JOB 2502-MC - www.montorio.ca - 780-250-0212