

Messina VI

Job 2445-ST

59 Silverstone Drive, Stony Plain

1,898 Sq.Ft.

9'-1" Main Floor Ceiling Height

Vinyl Plank throughout Main Floor

Quartz Countertops in Kitchen & Bathrooms

Tile in all Second Floor Bathrooms

Appliance Allowance

Smart Home Security System

Drop-in Tub & Stand-up Shower in Ensuite

Tandem Garage With Floor Drain

Railing Throughout

Electric Fireplace in Great Room

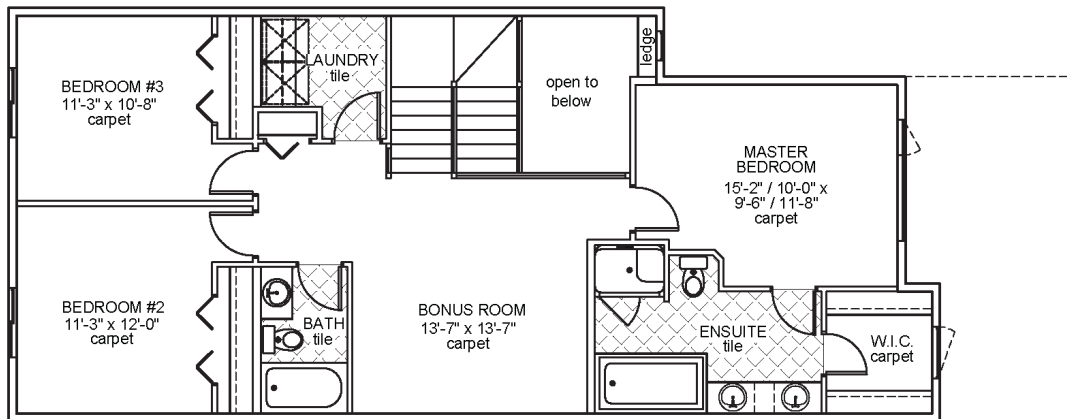

Upper Floor Area: 1076 sqft

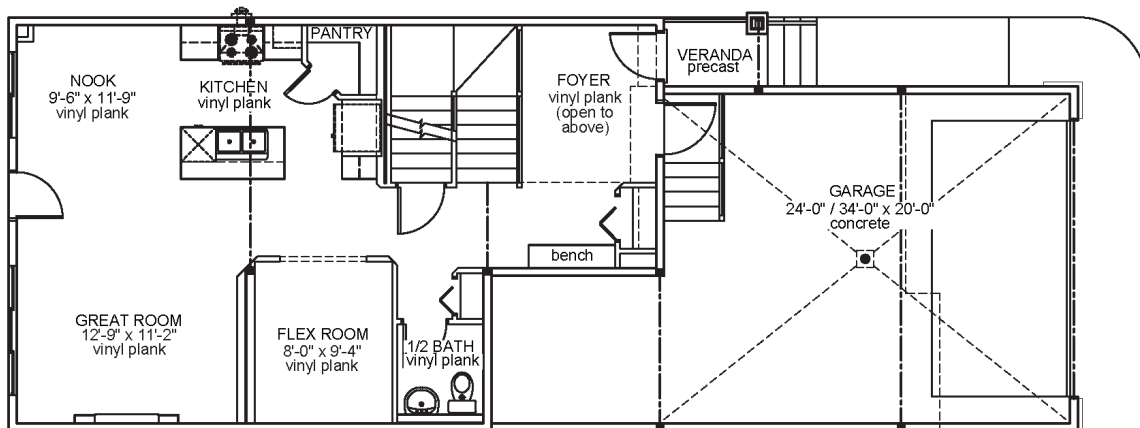

Main Floor Area: 822 sqft