



# Novara III

**Job 2452-MC**

17529 - 63A Street NW

1,433 Sq.Ft.

9'-1" Main Floor Ceiling Height

Vinyl Plank throughout Main Floor

Quartz Countertops in Kitchen & Bathrooms

Tile in all Second Floor Bathrooms

Appliance Allowance

Side Entrance

Stand-Up Shower in Ensuite

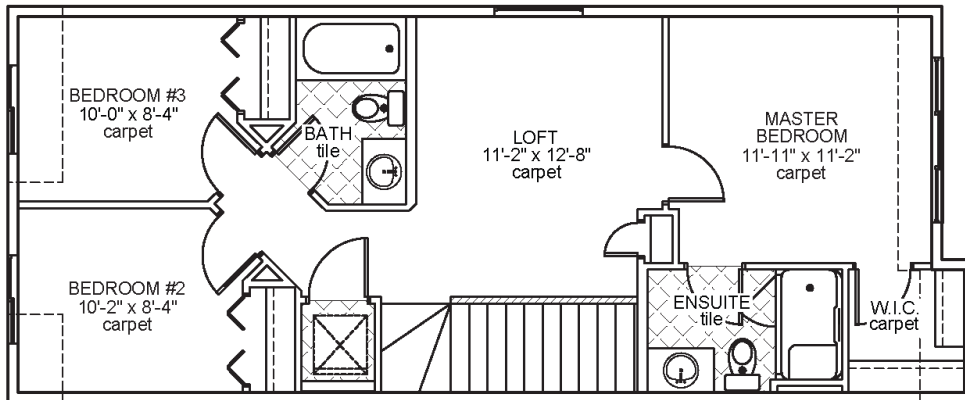

Upper Floor Area: 728 sqft

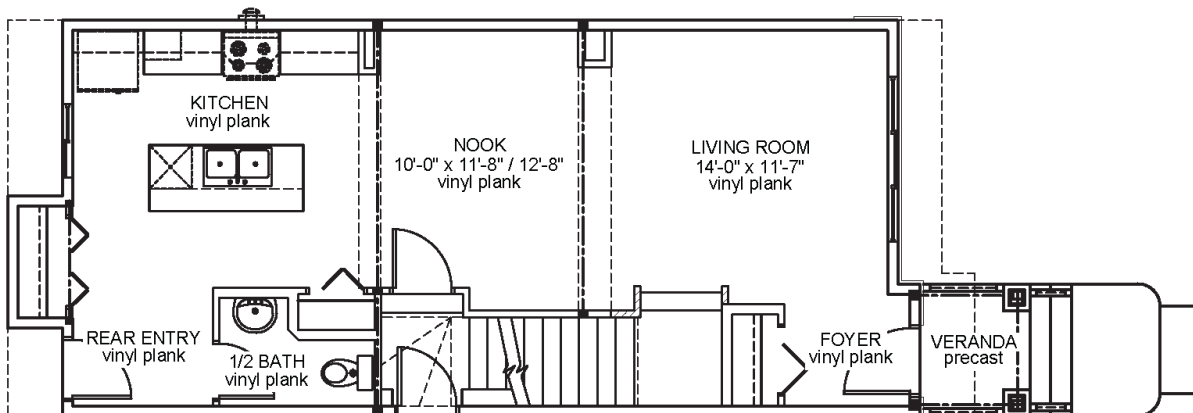

Main Floor Area: 705 sqft

