



Job # 2294

Novara II: 1269 ft²

**126 Dansereau Way
(Beaumont)**

- ✓ **9'-1" Main Floor Ceiling Height**
- ✓ **Vinyl Plank throughout Main Floor**
- ✓ **Quartz Countertops in Kitchen & Bathrooms**
- ✓ **Tile in all Second Floor Bathrooms**
- ✓ **Detached Garage Included**
- ✓ **Stand-Up Shower in Ensuite**
- ✓ **Rear Concrete Patio**
- ✓ **No Condo Fees**
- ✓ **Front & Rear Landscaping**

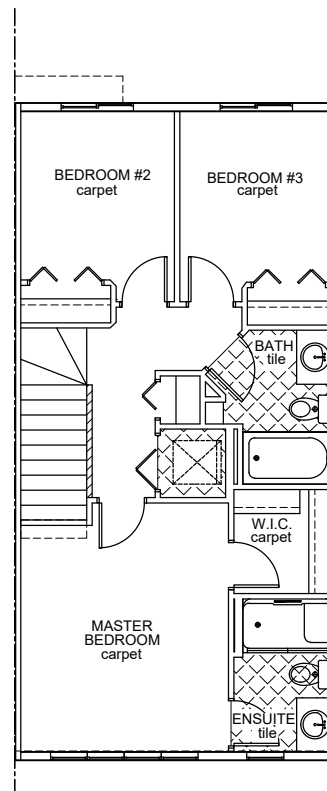
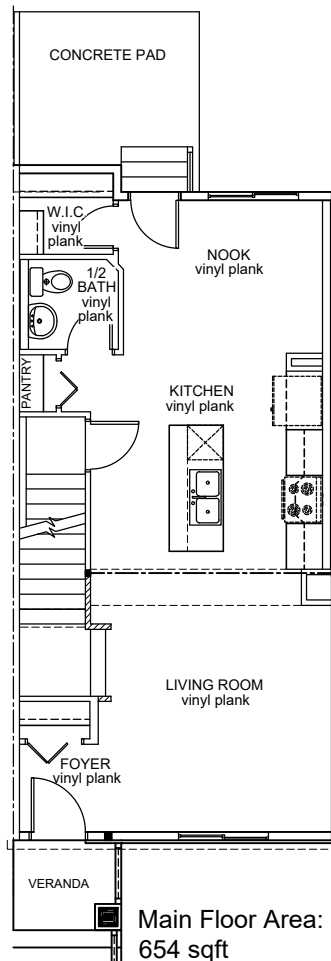

Upper Floor Area: 615 sqft