



Job # 2274

Novara I: 1408 ft²

**1538 - 157 Street SW
(Glenriding)**

- ✓ **9'-1" Main Floor Ceiling Height**
- ✓ **Vinyl Plank throughout Main Floor**
- ✓ **Quartz Countertops in Kitchen & Bathrooms**
- ✓ **Tile in all Second Floor Bathrooms**
- ✓ **Tandem Garage**
- ✓ **Stand-Up Shower in Ensuite**
- ✓ **Gas Line for BBQ**
- ✓ **Rear Wood Deck with Wood Railing**
- ✓ **No Condo Fees**
- ✓ **Front & Rear Landscaping**
- ✓ **Fencing**

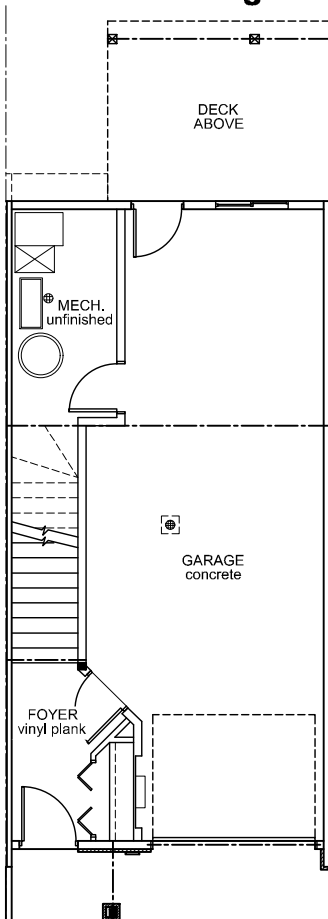

Ground Floor Area: 131 sqft

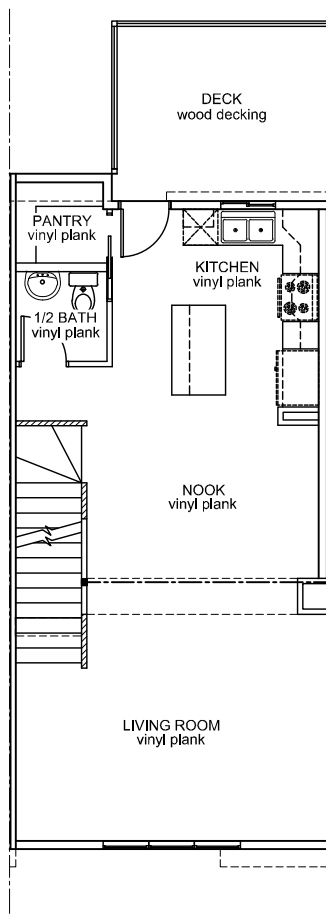

Main Floor Area: 657 sqft

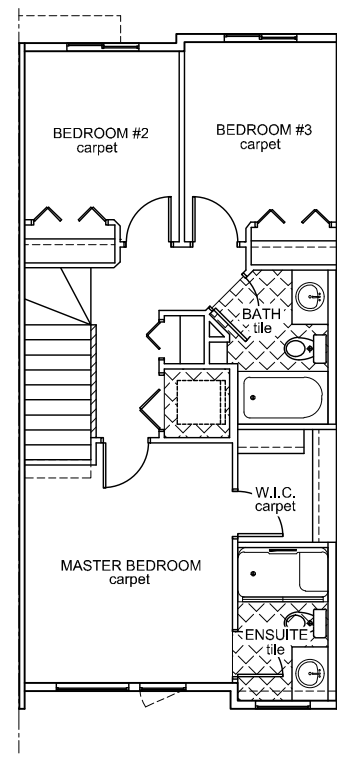

Upper Floor Area: 620 sqft